

AC/DC Geared Motor and Gearbox

Options

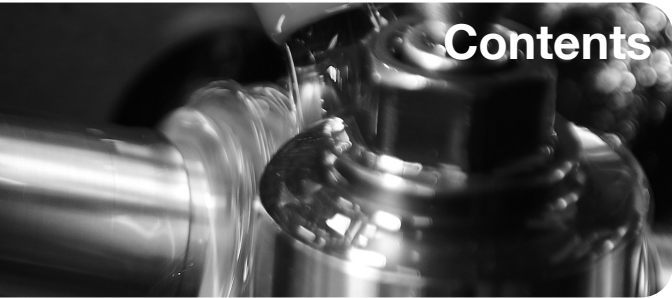

Contents

A Information

- A-01 Product Coding System
- A-04 Products Lineup
- A-09 감속기 분류조합표
- A-13 일반정보
- A-17 용어해설
- A-20 사용시 중요사항

B AC Motors

- B-01 AC Motor의 기술자료
- B-06 Induction Motor
- B-56 2 Pole Motor
- B-74 Reversible Motor
- B-110 Brake Motor
- B-160 Clutch & Brake Motor
- B-176 Torque Motor
- B-204 Speed Control System
 - B-207 Speed Controller FX3000
 - B-211 Speed Controller DX3000
 - B-215 Speed Controller DSA
 - B-217 Speed Controller DSKM
 - B-222 Speed Control Induction Motor
 - B-256 Speed Control Reversible Motor
 - B-286 Speed Control Brake Motor
 - B-320 Speed Control Clutch & Brake Motor
- B-334 DSY시리즈 모터&감속기 일체형

C DC Motors

- C-01 DC Motor의 기술자료
- C-04 DC Motor
- C-20 Speed Controller DSD-90

D Gearboxes

- D-01 감속기의 기술자료
- D-07 평행축 감속기
- D-13 직교축 감속기
- D-18 중간감속기

E Options

- E-01 브라켓
- E-03 연장선
- E-04 출력플랜지 / 출력샤프트

E Options

브라켓

Bracket

브라켓

모터와 감속기를 설치면에 고정하기 위해 필요한 장치로,
Frame Size 70mm, 80mm, 90mm 모터 및 감속기용 브라켓이 구비되어 있습니다.



Product Code



Dimensions

□ 70mm 부착용

● Model: DBKM-70

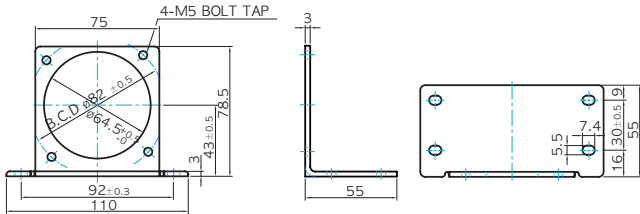

□ 80mm 부착용

● Model: DBKM-80

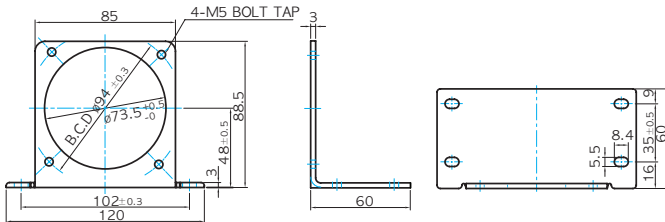

□ 90mm 부착용

● Model: DBKM-90

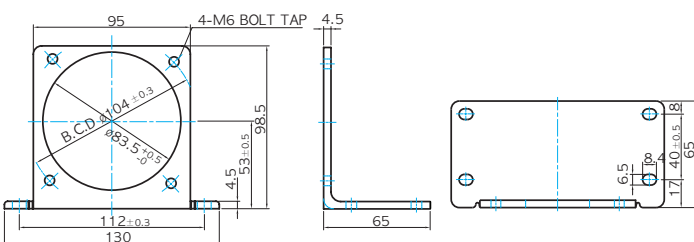

Product Code

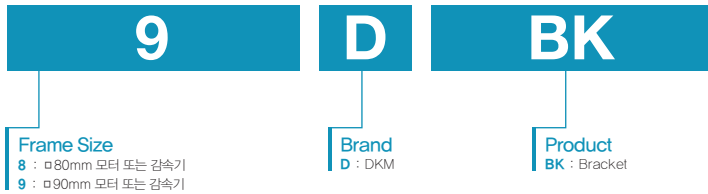

Dimensions

□ 80mm 부착용

● Model: 8DBK

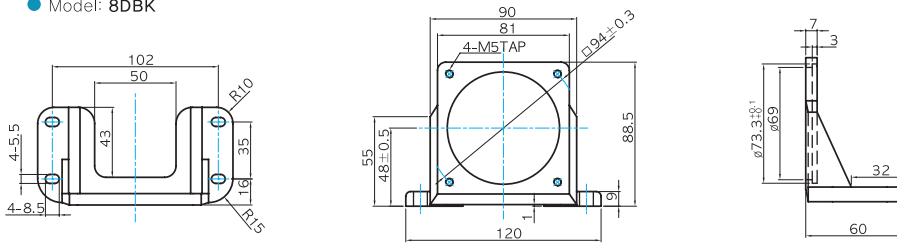

□ 90mm 부착용

● Model: 9DBK

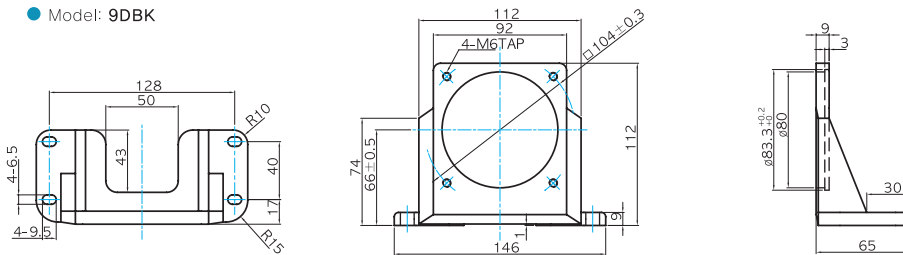

E Options

연장선

Extension Cable

연장선

스피드콘트롤 모터와 스피드콘트롤러를 연결하는데 사용되는 케이블입니다.
0.3m 연장선이 기본길기로 제공되며, 추가로 더 연장하여 사용하실 경우에는
연장선을 따로 구입하여 사용해 주십시오.



Dimension

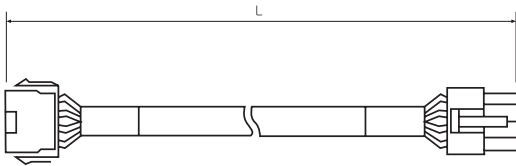

MODEL	연장선 길이 (L)
DEW-05	0.5m
DEW-10	1.0m
DEW-15	1.5m
DEW-20	2.0m
DEW-30	3.0m
DEW-50	5.0m

Flange(Output / Input)

중공축 웬타입 감속기용 출력플랜지 & 입력플랜지

중공축 웬타입 감속기에 출력플랜지를 부착하여 감속기를 설치면에 고정할 수 있습니다. (IEC타입 입력플랜지도 제공합니다.)



Dimensions

● MODEL: WHG-030-F

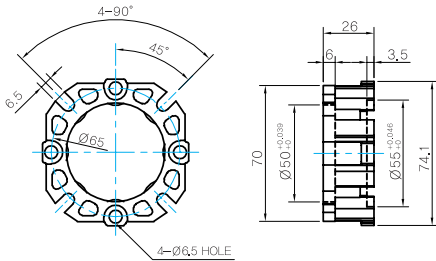

● MODEL: WHG-040-F

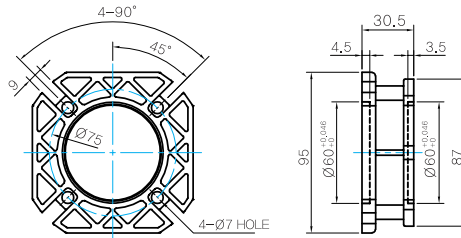

● MODEL: 040-Flange-71B5

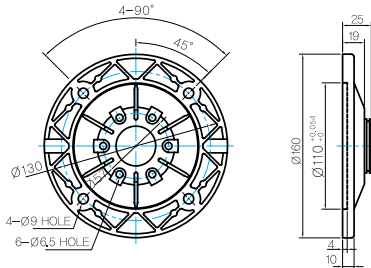

● MODEL: 040-Flange-71B14

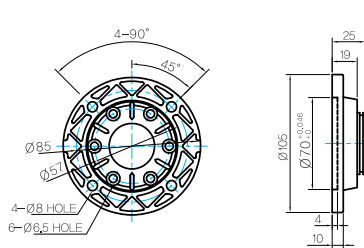

E

출력플랜지 / 출력샤프트

Output Shaft

중공축 웜타입 감속기용 샤프트



중공축 웜타입 감속기에 부착하는 출력축/샤프트입니다.
한방향 샤프트와 양방향 샤프트가 구비되어 있습니다.

Dimensions

● 한방향 MODEL: 030 Shaft-S

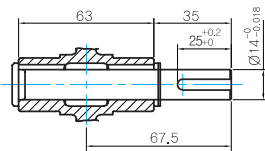

● 양방향 MODEL: 030 Shaft-D

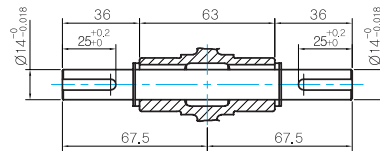

● KEY SPEC

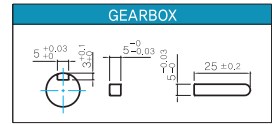

● 한방향 MODEL: 040 Shaft-S

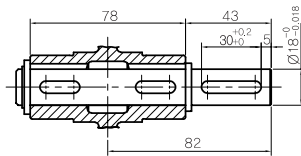

● 양방향 MODEL: 040 Shaft-D

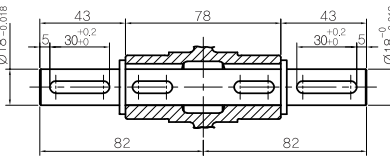

● KEY SPEC

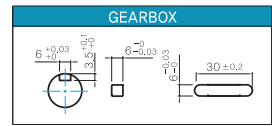

● MODEL : 9HC SHAFT-S-□
(적용감속기 : 9HC□□)

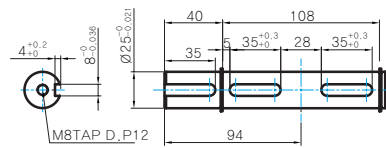

● KEY SPEC

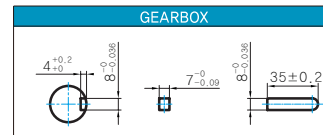

● MODEL : 10HC SHAFT-S-□
(적용감속기 : 10HC□□)

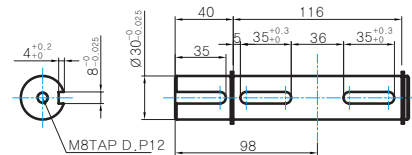

● KEY SPEC

